



Wire EDM

As a material removal production specialist, GO2cam meets the needs of Wire EDM machinists.

Industrialists of micromechanics, watch makers, precision engineering, forming tools manufacturers, every Wire EDM machine operator finds in GO2cam the answers to their time and quality standard requirements.



Straight/ taper cut

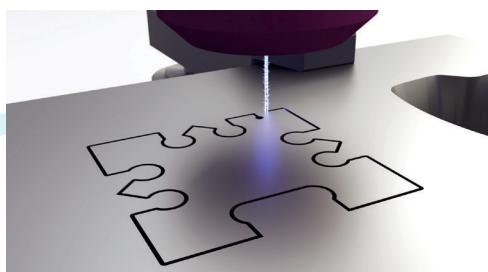

Pocketing/ Conic pocketing

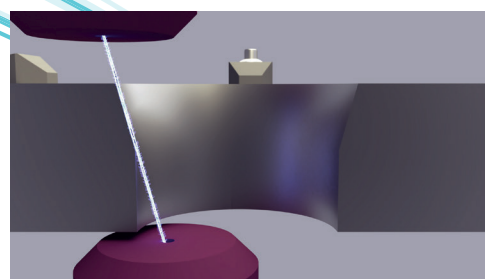

4 Axis Cut

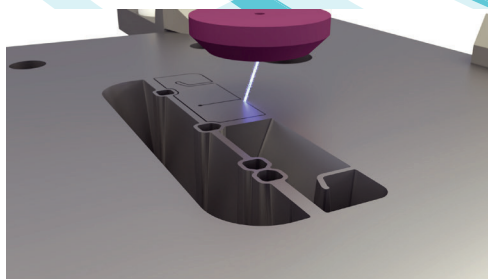



CAD

- Compatibility & associativity with CAD files (SolidWorks, Siemens PLM, CatiaV5, 3DEXperience, Creo),
- Parametric CAD kernel,
- Smart dimensioning based on average tolerance,
- Smart features: straight taper and 4 axis cut,
- Specific function to draw forming tool,
- Gear & toothing database (ISO and AGMA standard).

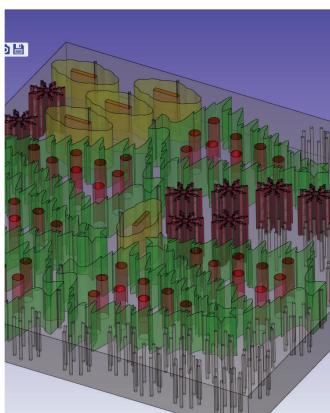

Nesting

Enables a perfect material optimization by keeping and re-using of partially started plates.

Extrusion die

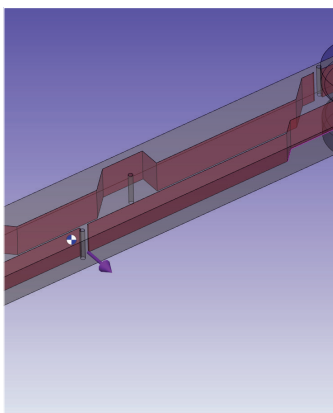
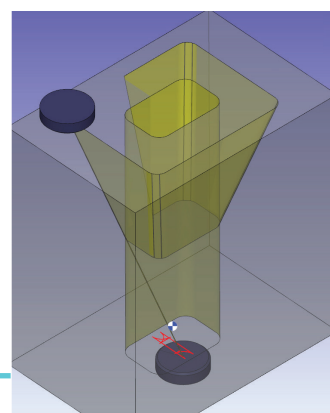

Multiple threading points

Forming Tool Manufacturing

Allows to export the final part geometry towards GO2cam Wire EDM, to create the exact opposite shaped tool. Then, the tailormade tool will be used to produce the part on a single faultless cycle.

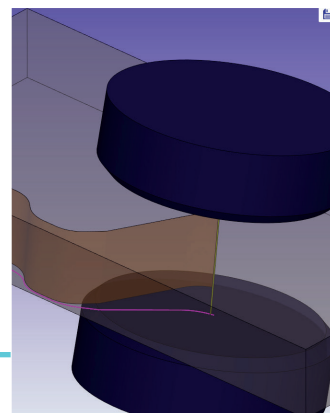

Scan QR code to find out more about our modules

Available add-ons: Swiss Turn Tool Manufacturing (STTM), User Workshop documents.



Wire EDM

