



# Swiss Machining

Quantity and quality! The main priority of Swiss Machining industrialists is to maintain a high and constant production rhythm, reaching requirement of total quality. A few tenths of seconds per part and the productivity takes off.

But today, production series on Swiss type machines are shorter and machines are more complex to program manually. For this reason, we created a dedicated solution for Swiss Machining which automatizes complex manipulations in order to enable users to handle it rapidly with dedicated workflow.

GO2cam incorporated into this product all the specific synchronization solutions dedicated to multi-channel CNC machines used by Swiss Machining specialists.

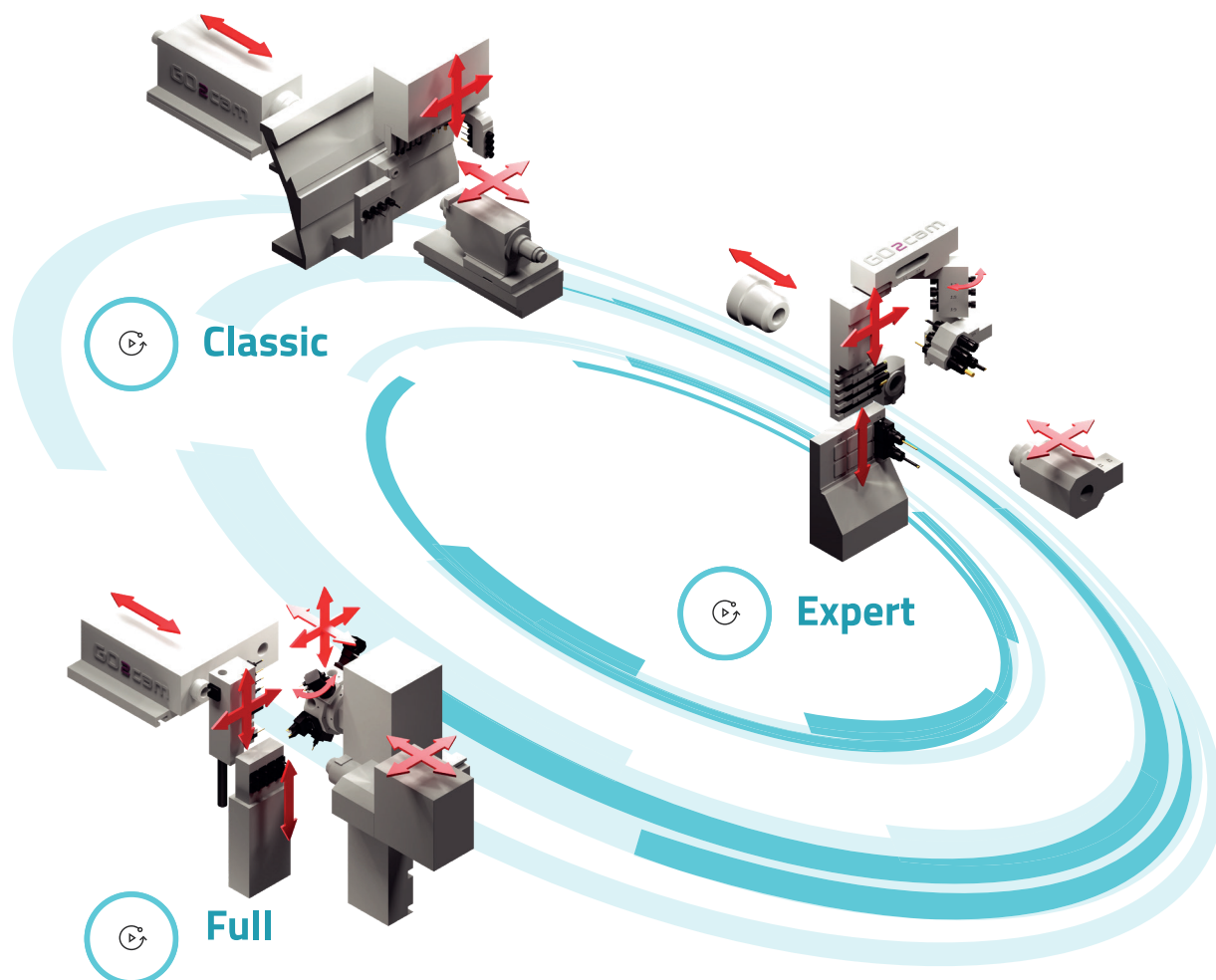

## CAD

- Compatibility & associativity with CAD files (SolidWorks, Siemens PLM, CatiaV5, 3DEXperience, Creo, SpaceClaim),
- Parametric CAD kernel,
- Smart dimensioning based on average tolerance .

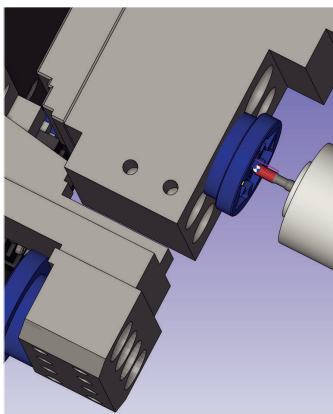
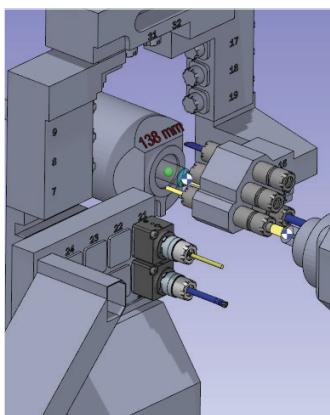

Scan QR code to find out more about our modules

## CAM

- Definition, preview and simulation of all synchronization operations including superimposition,
- Creation and edition of tools database for mounting (full-auto process),
- Management of the sliding headstock,
- Intuitive and interactive rearrangement of operations among gang tool,
- Simulation of raw material inside machine environment to avoid any collisions and errors,
- Post processor and machine environment simulation available,
- Management of items in part design table,
- Customized solution available.

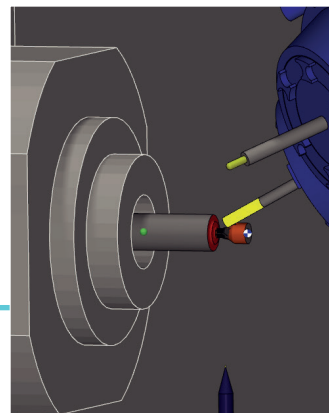

### Task Management & Synchronization

### 5 axis positioned or simultaneous

### Thread whirling

- Tool database available
- Dedicated cycles

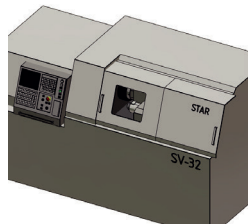

Star

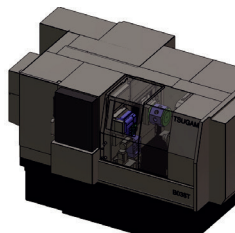

Tsugami

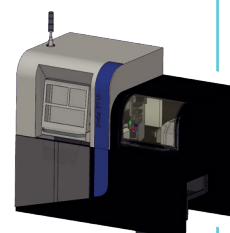

Tornos

But also Citizen, Traub, Nomura, Hanwha, Index, Miyano... & others



Swiss Machining